



## Design

The Hallite 864 is a double lipped metal cased wiper, designed to press-fit into open groove housings. Hallite's 864 wiper comprises a specially textured polyurethane wiping lip which is securely bonded to a nitrided metal case, eliminating the potential for rust. Opposite the wiping lip are two sealing lips accurately produced and proportioned to collect the fluid passing the rod seal. Capable of operating in dirty conditions, the proportions of the polyurethane wiping lip allow it to follow the side movement of the rod and to clear away heavily deposited dirt. The Hallite 864 wiper is designed for use with venting U-rings such as the Hallite 663 rod seal.

Suitable for light, medium and heavy duty applications, the wiper has been designed to provide ease of installation and offers excellent durability in service.

## Features

- Ease of assembly
- Long life
- Textured wiping lip minimising oil transfer
- Nitrided metal case
- Wide range of application uses

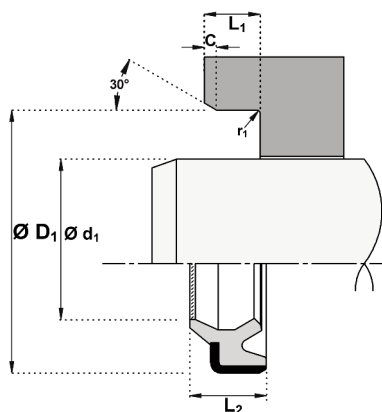

## Technical details

### Operating conditions

Maximum Speed	1.0 m/sec
Temperature Range	-45°C +110°C

### Inch

3.0 ft/sec
-50°F +230°F

### Surface roughness

	$\mu\text{mRa}$	$\mu\text{mRt}$
Dynamic Sealing Face $\varnothing d_1$	0.1 < > 0.4	4 max
Static Sealing Face $\varnothing D_1$	1.6 max	10 max
Static Housing Faces $L_1$	3.2 max	16 max

$\mu\text{inCLA}$	$\mu\text{inRMS}$
4 < > 16	5 < > 18
63 max	70 max
125 max	140 max

### Chamfers & Radii

Rod Diameter $\varnothing d_1$ mm	$\leq 19$	$\geq 19$
Min Chamfer C mm	0.5	1.0
Max Fillet Rad $r_1$ mm	0.4	0.4

### Tolerances

$\varnothing d_1$	$\varnothing D_1$	$L_1$ mm
f9	H8	+0.5 -0



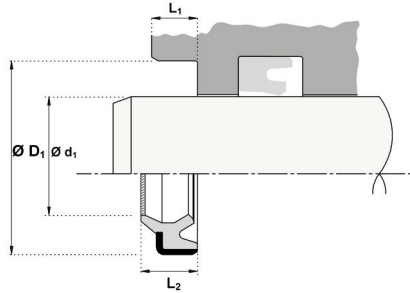

Ød <sub>1</sub>	TOL f9	ØD <sub>1</sub>	TOL H8	L <sub>1</sub> +0.5 -0	L <sub>2</sub>	PART No.
25	-0.020 -0.072	35	+0.039 +0.000	5.0	8.0	4680506
30	-0.020 -0.072	40	+0.039 +0.000	5.0	8.0	4680606
30	-0.020 -0.072	42	+0.039 +0.000	6.0	9.0	4680706
35	-0.025 -0.087	45	+0.039 +0.000	7.0	10.0	4680806
35	-0.025 -0.087	47	+0.039 +0.000	7.0	10.0	4680906
36	-0.025 -0.087	48	+0.039 +0.000	7.0	10.0	4683206
40	-0.025 -0.087	50	+0.039 +0.000	5.0	8.0	4681006
40	-0.025 -0.087	52	+0.046 +0.000	7.0	10.0	4681106
45	-0.025 -0.087	55	+0.046 +0.000	7.0	10.0	4681206
45	-0.025 -0.087	57	+0.046 +0.000	7.0	10.0	4681306
50	-0.025 -0.087	62	+0.046 +0.000	7.0	10.0	4680206
55	-0.030 -0.104	69	+0.046 +0.000	8.0	11.0	4681406
60	-0.030 -0.104	74	+0.046 +0.000	8.0	11.0	4681506
65	-0.030 -0.104	79	+0.046 +0.000	8.0	11.0	4681606

Ød <sub>1</sub>	TOL f9	ØD <sub>1</sub>	TOL H8	L <sub>1</sub> +0.5 -0	L <sub>2</sub>	PART No.
70	-0.030 -0.104	84	+0.054 +0.000	8.0	11.0	4681706
75	-0.030 -0.104	89	+0.054 +0.000	8.0	11.0	4681806
80	-0.030 -0.104	94	+0.054 +0.000	8.0	11.0	4681906
85	-0.036 -0.123	99	+0.054 +0.000	8.0	11.0	4682006
90	-0.036 -0.123	104	+0.054 +0.000	8.0	11.0	4682106
95	-0.036 -0.123	109	+0.054 +0.000	8.0	11.0	4682206
100	-0.036 -0.123	114	+0.054 +0.000	8.0	11.0	4682306
110	-0.036 -0.123	126	+0.063 +0.000	9.0	12.0	4682406
120	-0.036 -0.123	136	+0.063 +0.000	9.0	12.0	4682506
130	-0.043 -0.143	146	+0.063 +0.000	9.0	12.0	4682606
135	-0.043 -0.143	155	+0.063 +0.000	10.0	14.0	4683506
140	-0.043 -0.143	160	+0.063 +0.000	10.0	14.0	4682706
150	-0.043 -0.143	170	+0.063 +0.000	10.0	14.0	4682806
160	-0.043 -0.143	180	+0.063 +0.000	10.0	14.0	4682906

### Seal & Design Able Division

5533 Steeles Avenue West Unit 11  
Toronto, Ontario M9L 1S7  
Ph: (416) 741-0750  
Gasket@AbleSealAndDesign.com

### Seal & Design Corporate Headquarters

4015 Casilio Parkway  
Clarence, NY 14031  
Ph: (716) 759-2222  
Info@SealAndDesign.com  
www.SealAndDesign.com

### Seal & Design Higbee Division

6741 Thompson Rd N  
Syracuse, NY 13221  
Ph: (315) 432-8021  
Sales@Higbee-Inc.com